

Total No. of Pages : 02

Total No. of Questions : 06

B. Architecture (Sem.-5)
BUILDING CONSTRUCTION AND MATERIAL -V

Subject Code : AR-323

M.Code : 45038

Time : 4 Hrs.

Max. Marks : 75

INSTRUCTIONS TO CANDIDATES :

1. Attempt TWO questions from UNIT-I & ONE question from UNIT-II
2. Assume the missing data if any.

UNIT-I

1. Draft detailed working drawing of ground floor plan and roof plan for a single floor residence as per ground floor plan (fig-1.) attached on 1:50 scale. (25)
2. Draft detailed working drawing of vertical sections through stair case for a single floor residence as per floor plan (fig-1.) attached on 1:50 scale. Assume the foundation details, sill level, parapet level, lintel level, floor height etc. (25)
3. Locate the wardrobe in the bed room area and draft the detailed working drawing for the same of plan attached as fig.1 on 1:20 scale. (25)
4. Draft detailed working drawing of vertical sections through toilet and cut out for a single floor residence as per floor plan (fig-1.) attached on 1:50 scale. Assume the foundation details, sill level, parapet level, lintel level, floor height etc. (25)

UNIT-II

5. Enlist the different types of scaffolding. Sketch scaffolding details for three story high office building. (25)
6. Write short notes on followings with neat sketches : (12.5×2=25)
 - a) Underpinning for a heritage structure.
 - b) Close timber shoring

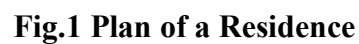

www.FirstRanker.com