

**GUJARAT TECHNOLOGICAL UNIVERSITY****BE - SEMESTER-VII (NEW) EXAMINATION – WINTER 2018****Subject Code: 2170610****Date: 29/11/2018****Subject Name: Professional Practices & Valuation****Time: 10:30 AM TO 01:00 PM****Total Marks: 70****Instructions:**

1. Attempt all questions.
2. Make suitable assumptions wherever necessary.
3. Figures to the right indicate full marks.

- Q.1** (a) Discuss accuracy criteria for concrete. **03**  
(b) Define specification. What are the purpose of writing. **04**  
(c) Calculate the following quantities for residential quarters shown in drawing. **07**  
( refer fig 1 ) [1] Excavation for Foundation [2] Brick bate cement concrete {1:4:8} for foundation[3] Brick masonry up to plinth C.M {1:6}
- Q.2** (a) Explain in detail various reasons for termination of contract. **03**  
(b) Define rate analysis. How to fixed rate per unit of item in rate analysis? **04**  
(c) Discuss measurement method for road work. **07**
- OR**
- (c) Calculate the following: **07**  
1. No. of bricks required for 1 cu. m. brick work.  
2. No. of cement bags for 1 cu.m brick work in cement mortar 1:4
- Q.3** (a) Define following terms – Estimate, Contingencies, Spot Item **03**  
(b) Differentiate between Estimation & Valuation **04**  
(c) Explain the following types of engineering contracts –( 1) Item Rate Contract (2) percentage rate of contract ( 3) Lump Sum Contract **07**
- OR**
- Q.3** (a) What do you mean by value ? State the purposes of Valuation. **03**  
(b) Enlist different types of tenders & explain anyone them. **04**  
(c) Write detail specifications for Earthwork in excavation in foundation. **07**
- Q.4** (a) Write short note on Schedule of rates (S.O.R) **03**  
(b) Enlist the various methods of valuation and explain any one in detail. **04**  
(c) Define tender and draft a typical tender notice for civil engineering works. **07**
- OR**
- Q.4** (a) Discuss various conditions of contract. **03**  
(b) Write difference between : 'Depreciation and Obsolescence.' **04**  
(c) A machine is purchased for Rs-1,00,000. Assuming its life 12 years its 10% salvage value. Calculate the amount of depreciation at the end of third year in a tabular form by using following methods –( 1) Straight Line Method (2) Constant Percentag Method. **07**
- Q.5** (a) Explain : 1.Tender fee, 2. Earnest money deposition **03**  
(b) Explain in brief about work charge establishment. **04**  
(c) How would you determine value of the property using rental method of valuation? Enumerate its advantages and limitations. **07**
- OR**
- Q.5** (a) Write formulas for the following: (1) Area of Segment of Circle (2) Area of ellipse (3) Curved surface area of cylinder **03**

- (b) Compare revised estimate and supplementary estimate [www.FirstRanker.com](http://www.FirstRanker.com) 04
- (c) Discuss mode of payment to the contractor. How the first and final bill, running or interim bills are paid to contractor? [www.FirstRanker.com](http://www.FirstRanker.com) 07

\*\*\*\*\*

[www.FirstRanker.com](http://www.FirstRanker.com)

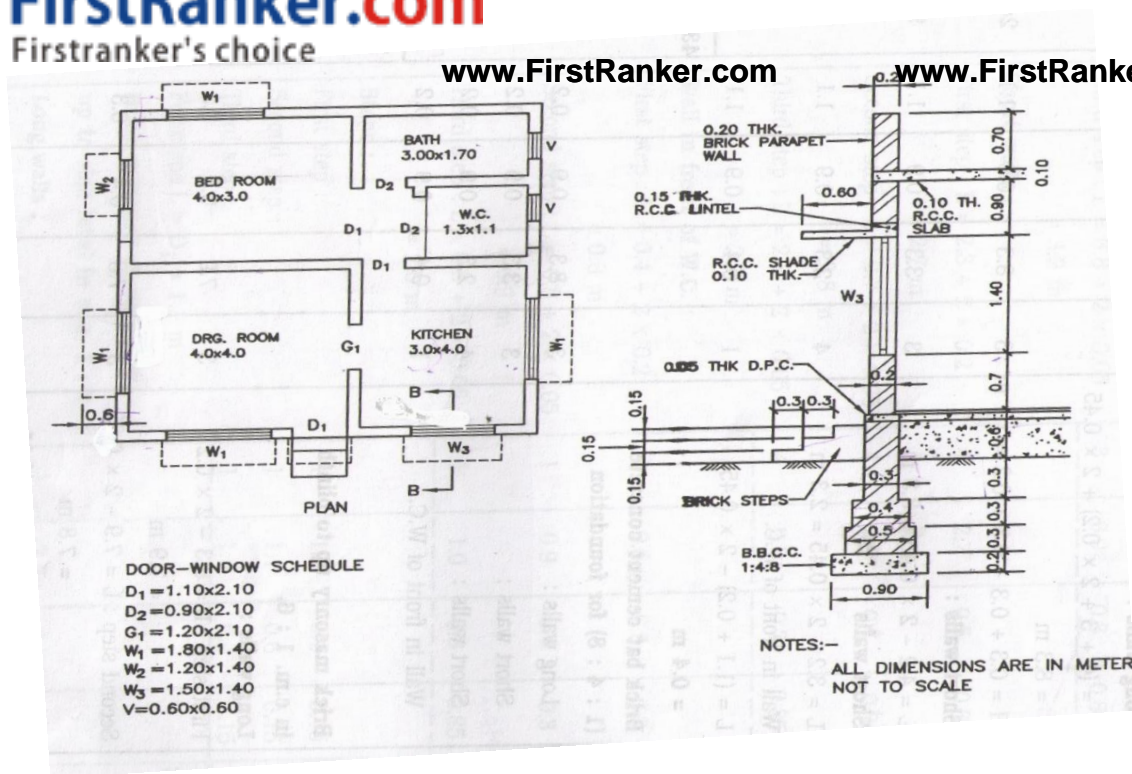

Figure 1

www.FirstRanker.com