

Total No. of Questions : 04

B. Architecture (2012 & Onwards) (Sem.-2)

ARCHITECTURAL DRAWING – II

Subject Code : BACH-203

M.Code : 45091

Time : 04 Hrs.

Max. Marks : 50

INSTRUCTIONS TO CANDIDATES :

1. Attempt TWO questions in all, selecting at least one from each unit.
2. Choose appropriate scale for drawing.

UNIT-I

- 1) Draw the perspective view of a square pyramid of base 100 mm side and height of the apex 120 mm. The nearest edge of the base is parallel to and 30 mm behind the picture plane. The station point is situated at a distance of 300 mm from the picture plane, 60 mm above the ground plane and 200 mm to the right of the apex. (25)
- 2) The object shown in the Figure 1 rests on its base on the ground with one of its vertical faces touching the picture plane. The station point is 30 mm away from the object and 60 mm from the picture plane. The horizon plane is 70 mm above the ground. Draw the perspective view of the object. (25)

UNIT II

- 3) A pentagonal prism of base edge 25 mm and height 60 mm is resting on one of its rectangular faces on the ground with the axis parallel to both the planes of reference. Draw the isometric projection of the object. (25)
- 4) A right regular octagonal prism, edge of base 20mm and height 50mm, has a circular hole of 20mm diameter drilled centrally through it, along its axis. Draw its isometric projection. (25)

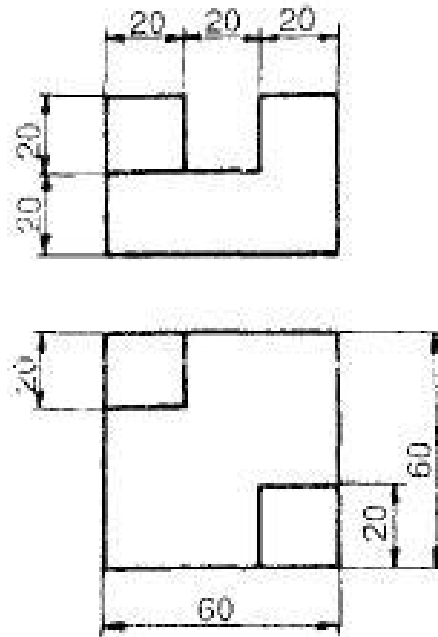

Figure 1

NOTE : Disclosure of Identity by writing Mobile No. or Making of passing request on any page of Answer Sheet will lead to UMC against the Student.